

# KOBRA 240 SS4

CLASSIC LINE SHREDDER  
PERSONAL USE AND SMALL/MEDIUM OFFICES



Mode: KOBRA 240 SS4  
Article Code: 99.706  
EAN Code: 8 026064 997065



|  |   |
|--|---|
| Throat width:                                | 9.5 inch  |
| Shred size:                                  | 1/8 inch straight cut   |
| Security level<br>ISO/IEC 21964 (DIN 66399): | P-2 O-2 T-2 E-2   |
| Paper capacity*<br>(sheets at a time):       | up to 26 sheets   |
| Shreddable materials:                        | Paper, Credit cards, Credit cards with chip, CDs/<br>DVDs, Floppy-disks |
| Waste bag volume:                            | 9.5 gal   |
| Speed:                                       | 22 ft/min   |
| Noise level:                                 | 55 dB(A)  |
| Voltage:                                     | 115 Volt / 60 Hz  |
| Power:                                       | 3/4 HP  |
| Dimensions (WxDxH):                          | 14.5 x 13 x 22 inch   |
| Weight:                                      | 33 lbs – Packaging: 1 unit per box                                      |

Datasheet n.22 rev.0

\* Capacity varies on supply power, weight, quality and grain of paper,  
operating temperature and blade lubrication

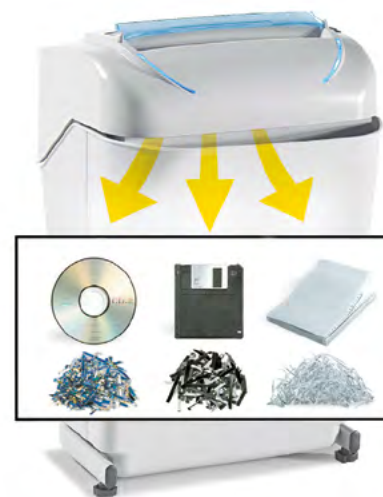

Certifications **CB** **SP** **CE**  
C US

Trade Agreement Act (TAA) Compliant

## MAIN FEATURES

Straight-cut shredder equipped with heavy duty chain drive system with metal gears. Carbon hardened cutting knives unaffected by staples and clips. Motor thermal protection: 24 hour continuous duty operations without overheating or duty cycles.

Kobra 240 SS4 can shred up to 26 sheets at a time, CDs/DVDs, credit cards and floppy-disks. Energy Smart System with optical illuminated indicators for power saving stand-by mode and environmental protection. Equipped with a removable waste bin for easy empty operations, does not require lifting of the cutting head.

- **Super Potential Power Unit:** heavy duty chain drive system with steel gears
- **Continuous duty shredding:** 24 hour continuous duty motor without overheating and duty cycles. Motor thermal protection.
- **Carbon hardened steel cutting knives** unaffected by staples and clips
- **Energy Smart System:** power saving stand-by mode with optical illuminated indicators
- **Oil-free System:** no need of lubrication and maintenance of cutting knives
- **Start & Stop:** automatic start and stop through electronic eyes with stand-by function
- **Safety Stop:** automatically stops at bin removal
- **Removable waste bin** for easy empty operations: does not require lifting the cutting head. Equipped with a mechanism to separate shredded paper from plastic shreds.
- **Eco-friendly:** does not require plastic bags.



### 24 HOUR CONTINUOUS DUTY MOTOR

Motor thermal protection. Continuous duty motor, no overheating and no duty cycles. Carbon hardened steel cutting knives unaffected by staples and clips.



### SUPER POTENTIAL POWER UNIT

Heavy duty chain drive with steel gears which offer reliability and resistance to wear.



### ENERGY SMART SYSTEM

Optical illuminated indicators for power saving stand-by mode.



### REMOVABLE WASTE BIN

for easy empty operations: does not require lifting the cutting head. Equipped with a mechanism to separate shredded paper from plastic shreds.

**ADVANTAGE**  
BUSINESS EQUIPMENT

**WWW.ABE-Online.com**  
**TEL: 800-560-2242**