

Standard Features:

- Photo eye sensor automatically starts/stops feeding
- Neatly slits the edge of envelopes, leaving contents intact and no messy paper scraps to remove
- Processes up to 200 envelopes per minute
- Handles a variety of envelope sizes, from #10 to 10" x 13" flats
- Compact and quiet, ideal for the office environment
- Freestanding adjustable catch tray
- Infeed extension supports large envelopes

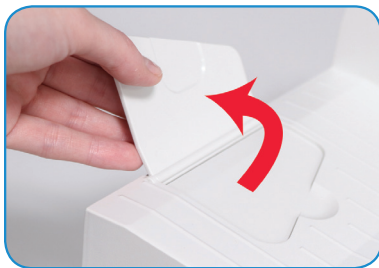

Easy-to-use infeed extension supports large envelopes up to 10" x 13"

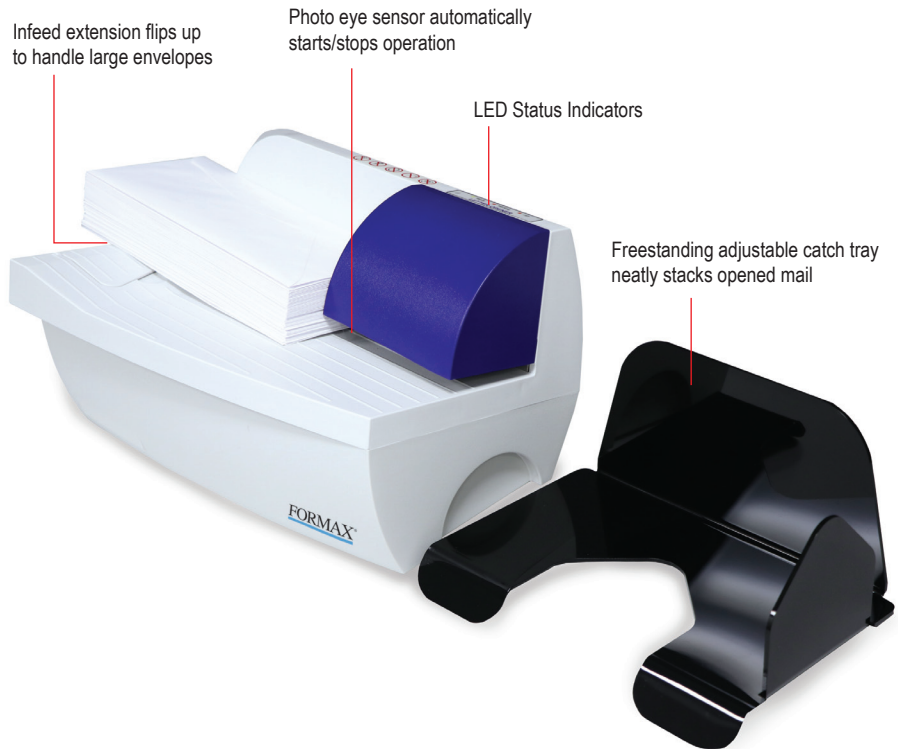

LED status indicators

Quick, Simple, Compact

Maximize productivity and distribute incoming mail faster with the Formax FD 442 Envelope Opener.

The FD 442 has user-friendly features and is easy to set up. Simply load mail on the infeed, and that's it! Within seconds mail is open and ready, thanks to the photo sensor eye which automatically starts and stops the feeder.

The innovative cutting mechanism slits one side of the envelope from end to end, so the contents are left undamaged, with no messy paper scraps to clean up.

The FD 442 opens mixed mail up to 4mm thick, in sizes up to 10" x 13". Simply flip up the infeed extension to support large envelopes, and adjust the freestanding catch tray to stack them neatly. With a speed of up to 200 envelopes per minute, your mail will be ready in no time.

Specifications:

| | |
|------------------------------------|---|
| Speed: | Up to 200 envelopes per minute |
| Feeder Style/Capacity: | Bottom feed, approximately 15 envelopes per stack |
| Envelope Sizes: | Up to 10" x 13", recommended for #9, #10, 6" x 9" |
| Envelope Thickness: | Up to 3/16" (4mm) |
| Automatic Start/Stop: | Photo eye sensor |
| Automatic, Self-Adjusting Feeding: | Adapts to various envelope thicknesses |
| Dimensions: | 13" L x 9" D x 7" H (not including 9.5" catch tray) |
| Weight: | 10 lbs. (4.4 kg) |
| Power: | 100-240 VAC 50/60 Hz |